

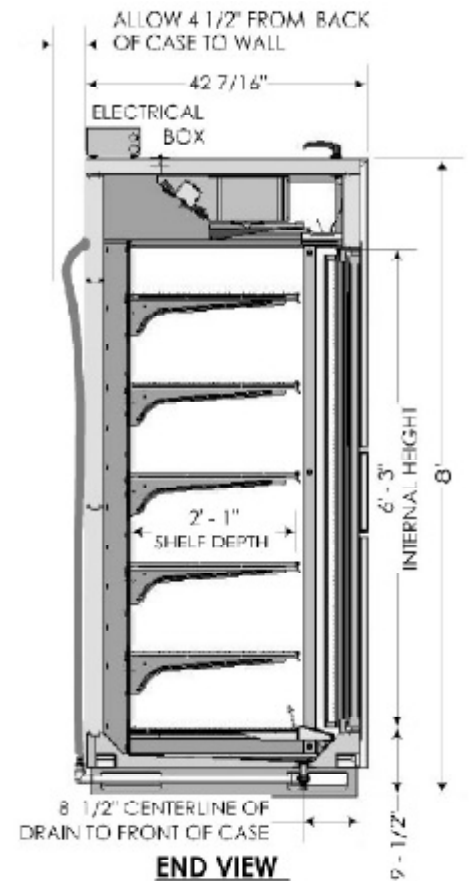

# RMZC30XL SPECIFICATION SHEET

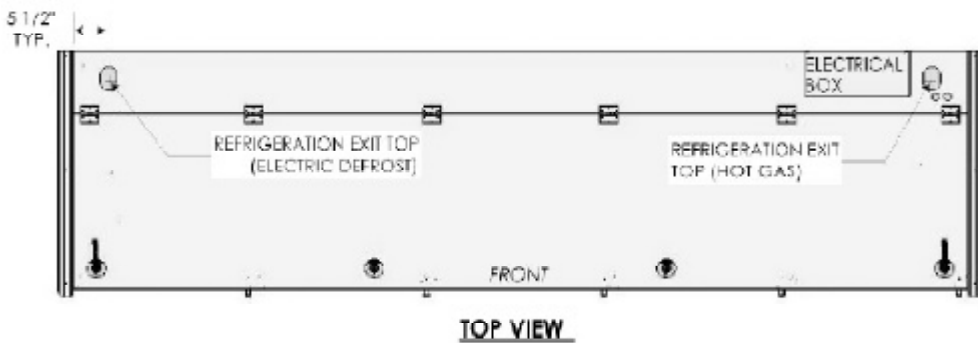
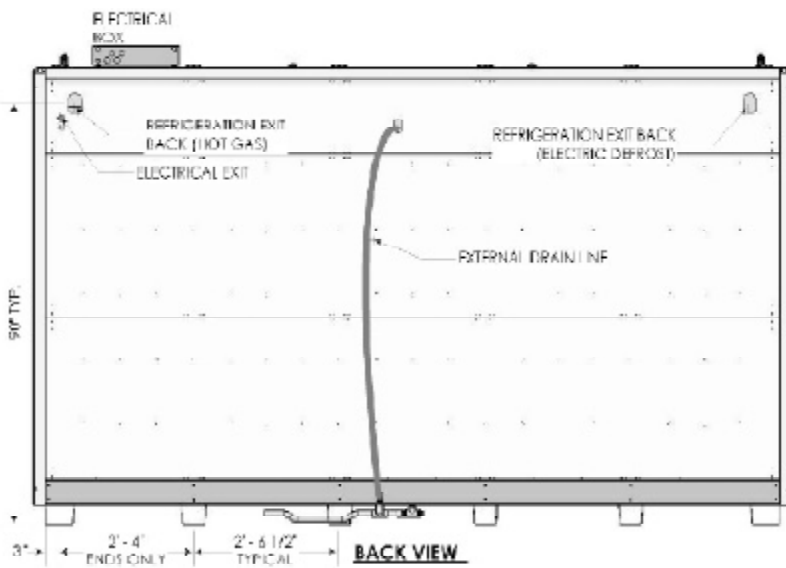
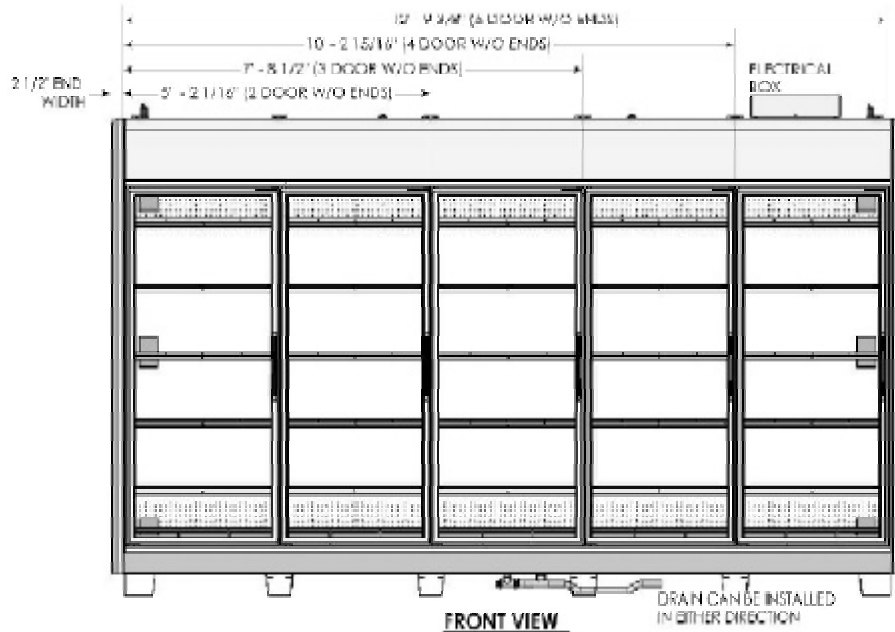

Zero Zone, Inc. • 110 N. Oakridge Dr.  
 North Prairie, WI 53153-9792  
 1-800-247-4496 • FAX: 262-392-6450  
 www.zero-zone.com

All specifications are subject to change without notice.



# RMZC30XL SPECIFICATION SHEET

CAPACITY SPECIFICATIONS		
CASE SIZE	CAPACITIES	
	USABLE CAPACITY	SHELF DEPTH
2RMZC30XL	66	25
3RMZC30XL	99	25
4RMZC30XL	131	25
5RMZC30XL	164	25

CASE SIZE	WEIGHT IN POUNDS*
2RMZC30XL	945
3RMZC30XL	1,315
4RMZC30XL	1,761
5RMZC30XL	2,244

\*WEIGHT BASED ON UNCRATED CASES WITHOUT ENDS, AND FULLY SHELVED.  
SINGLE END WEIGHT:  
65 POUNDS

### Electrical Specifications (All Cases)

MODEL NUMBER	T-8 LIGHTING AMPS	DRAIN AND DRAIN PAN AMPS	DEFROST HEATER AMPS 208V/1PH/60Hz
2RMZC30XL	1.88	4.01	6.73
3RMZC30XL	2.50	5.87	10.10
4RMZC30XL	3.13	7.73	13.46
5RMZC30XL	3.75	9.59	16.83

### Electrical Specifications (Variable depending on options)

MODEL NUMBER	FAN AMPS		DOOR ANTISWEAT AMPS	FRAME ANTISWEAT AMPS
	STANDARD FANS	PSC FANS	ANTHONY 101 w/ELS Lighting	ANTHONY 101
2RMZC30XL	1.02	0.45	2.08	3.43
3RMZC30XL	1.36	0.60	3.12	4.53
4RMZC30XL	1.70	0.75	4.16	5.67
5RMZC30XL	2.04	0.90	5.20	7.01

RACK-RATED BTUS NON-WINDOWED ENDS	Standard Doors and Standard Fan Motors		Standard Doors and PSC Fan Motors	
	FF	IC	FF	IC
2RMZC30XL	3,680	4,000	3,510	3,830
3RMZC30XL	5,520	6,000	5,290	5,770
4RMZC30XL	7,360	8,000	7,080	7,720
5RMZC30XL	9,200	10,000	8,860	9,660

Zero Zone, Inc. • 110 N. Oakridge Dr.  
North Prairie, WI 53153-9792  
1-800-247-4496 • FAX: 262-392-6450  
www.zero-zone.com

All specifications are subject to change without notice.