

DETAIL A

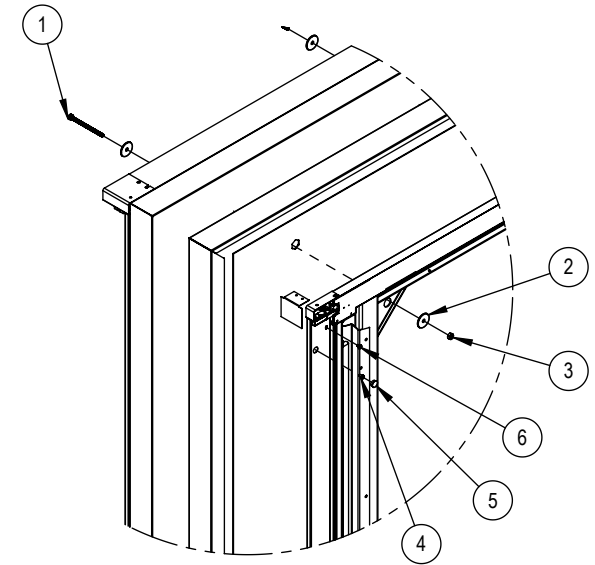

DETAIL B

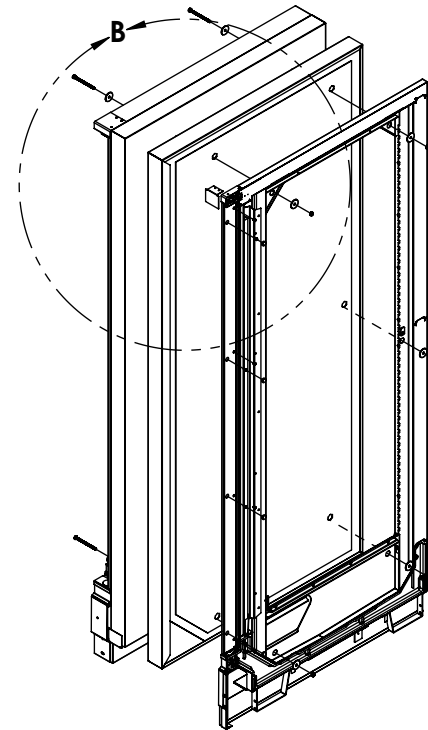
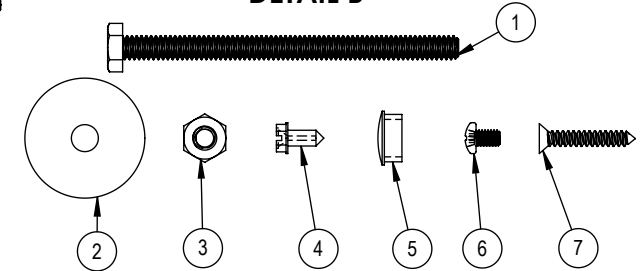

JOINING INSTRUCTIONS

1. CAULK CASE JOINTS FOLLOWING 66-0003 CASE JOINING AND 66-0004 NSF FIELD CAULKING INSTRUCTIONS.
2. ALIGN OPPOSITE ENDS OF TWO CASES TO BE JOINED.
3. THERE ARE 5 BOLTS AND WASHERS FACTORY INSTALLED HOLDING THE INSULATED DIVIDER TO CASE (SEE DETAIL A). REMOVE EACH OF THESE BOLTS AND WASHERS 1 AT A TIME. DO NOT REMOVE DIVIDER FROM CASE.
4. REMOVE ONE BOLT AND WASHER. REPLACE BOLT WITH ITEM 1, AND RE-USE WASHER. ITEM 1 WILL GO THROUGH THE WHOLE INSULATED DIVIDER INTO OTHER CASE, WHERE YOU WILL ATTACH ITEMS 2 AND 3. (SEE DETAIL B). HAND TIGHTEN.
5. REPEAT STEP 4 UNTIL ALL FACTORY INSTALLED HARDWARE HAS BEEN REMOVED.
6. MAKE SURE INSULATED DIVIDER IS ALIGNED WITH CASE.
7. ALTERNATE TIGHTENING EACH NUT AND BOLT EQUALLY UNTIL THE CASES ARE JOINED TOGETHER EVENLY, FORMING A TIGHT SEAL BETWEEN THE INSULATED DIVIDER AND THE CASE. DO NOT USE THE HARDWARE TO PULL THE CASES TOGETHER.
8. INSTALL ITEM 6 INTO VERTICAL RACEWAY COVER (4 PLACES). THIS WILL FASTEN TO THE VERTICAL RACEWAY.
9. INSTALL ITEM 4 INTO VERTICAL RACEWAY COVER (4 PLACES). THIS WILL FASTEN TO THE INSULATED DIVIDER.
10. INSTALL ITEM 5 INTO VERTICAL RACEWAY COVER (4 PLACES). THIS WILL COVER THE PREVIOUSLY INSTALLED SCREWS.
11. INSTALL ITEM 7 INTO FRAME WHEN JOINING EVOLUTION TO INSULATED DIVIDER (4 PLACES).
12. MIRROR JOINING INSTRUCTIONS IF INSULATED DIVIDER IS ON OPPOSITE SIDE OF CASE.

HARDWARE			
ITEM NO.	PART NUMBER	DESCRIPTION	QTY
1	64-0406	BOLT 1/4-20X 3-1/2 HEX TAP GR 8 ZN	5
2	64-0199	WASHER FNDR ZP 9/32 ID 1-1/4 OD	5
3	64-0308	NUT HEX 1/2-20 FINISH GR 8 ZN/YE	5
4	64-0610	SCREW 8-15 X 3/8 HES HD ZP TYPE A	4
5	64-0527-P1	HEYCO SHORTY HOLE PLUG, BLACK	4
6	64-0127	SCREW 8 X 1/4 PHIL PAN HD SMS ZP	4
7	64-0269	SCREW #8-18X1" PH FLAT T/S/AB/STLZN	4
8	82-0006	CAULK BUTYL/TUBES WHT	2

*** ITEMS 1, 2, 3, AND 7 PART #S END WITH A -P1 FOR BLACK INTERIOR.

ZERO ZONE, INC.
110 NORTH OAKRIDGE DRIVE
NORTH PRAIRIE, WISCONSIN
USA 53153



COPYRIGHT INFORMATION
THIS DRAWING AND THE INFORMATION CONTAINED WITHIN, IS
THE SOLE PROPERTY OF ZERO ZONE, INC. ANY USE OF THIS
DOCUMENT OR DISCLOSURE OF ITS CONTENTS, BY
REPRODUCTION OR OTHER MEANS, WITHOUT THE WRITTEN
CONSENT OF ZERO ZONE, INC. IS STRICTLY PROHIBITED.

DESCRIPTION:
Instructions Insulated Divider Joining kit
RHCC/RH2C to RHCC/RH2C/RVCC/RV2C

DRAWING No:
66-0020

REVISION
E