



Crystal™ Merchandiser RVMC24BBUN Back-to-Back Ultra Narrow Specs

Medium Temp Back-to-Back Ultra Narrow Reach-Ins with 24" x 74" CoolView™ Doors

RVMC24BBUN-(B,D,P): (B=Beverage, D=Dairy/Deli, P=Produce)

Note: Zero Zone display cases manufactured for shipment within the U.S. meet or exceed current DOE energy requirements.

ENERGY DATA

Refrigeration <small>(see note #1 for components included in baseline Btuh)</small>	LINEUP DATA		INDIVIDUAL CASE DATA (Includes 1 Pair of End Panels)			
	Per Door Avg.		2-Door (4')		3-Door (6')	
Evaporator Temperature (°F)	28		28		28	
Baseline Btuh ^{1,2}	410		930		1,360	
Discharge Air Temp. (°F) (w/ 8°F Superheat)	33		33		33	
Btuh Adders	Btuh					
Rail Heated Doors (Zero Zone CoolView Ultra™)	10					
Rail & Glass Heated Doors (Zero Zone CoolView Ultra™)	30					
Fan Motors (115V) ³	Amps	Watts	Amps	Watts	Amps	Watts
High Efficiency Electronic (SSC/ECM)	0.30	8	0.60	15	0.60	22
Lighting System (120V) (other LED options available)	Amps	Watts	Amps	Watts	Amps	Watts
LED Lighting (Zero Zone ChillBrite™ 4)	0.15	18	0.30	36	0.48	58
Anti-Sweat Door Heaters (115V)	Amps	Watts	Amps	Watts	Amps	Watts
No-Energy Doors (Zero Zone CoolView Ultra™)	0.00	0	0.00	0	0.00	0
Rail Heated Doors (Zero Zone CoolView Ultra™)	0.05	6	0.09	10	0.14	16
Rail & Glass Heated Doors (Zero Zone CoolView Ultra™)	0.16	18	0.31	36	0.47	54

Notes:

1. Baseline Evaporator Btuh based on parallel rack system, LED lighting (Zero Zone ChillBrite™ 4), no-energy doors (Zero Zone CoolView Ultra™), and SSC electronic fan motors.
2. For condensing units (non-rack system), multiply total Btuh rating by 1.08.
3. Amps are based on electrical nameplate values; watts are based on laboratory observations of actual energy use.

PHYSICAL DATA

Baseline R-404A Refrigeration Piping (Per Side)	Outlet Size (in.)	# of Doors	Weight (lbs.)	Case Capacity	
				Facings (ft. ²)	Packout (ft. ³) 24" Shelves
Suction Line O.D. (Top Refrig.)	1/2	2	TBD	47.2	53.0
Liquid Line O.D.	3/8	3 End Panel	TBD 50	70.4 N/A	79.0 N/A



Crystal™ Merchandiser RVMC24BBUN Back-to-Back Ultra Narrow Specs

Medium Temp Back-to-Back Ultra Narrow Reach-Ins with 24" x 74" CoolView™ Doors

RVMC24BBUN-(B,D,P): (B=Beverage, D=Dairy/Deli, P=Produce)

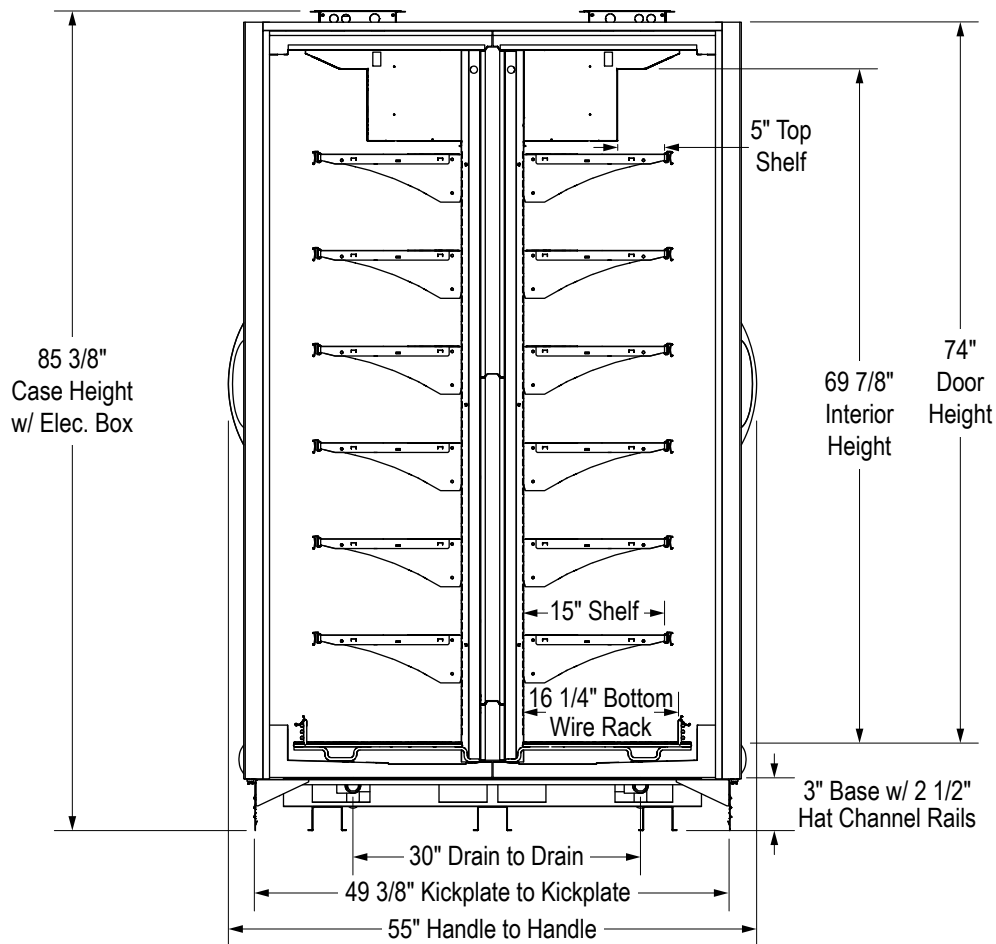
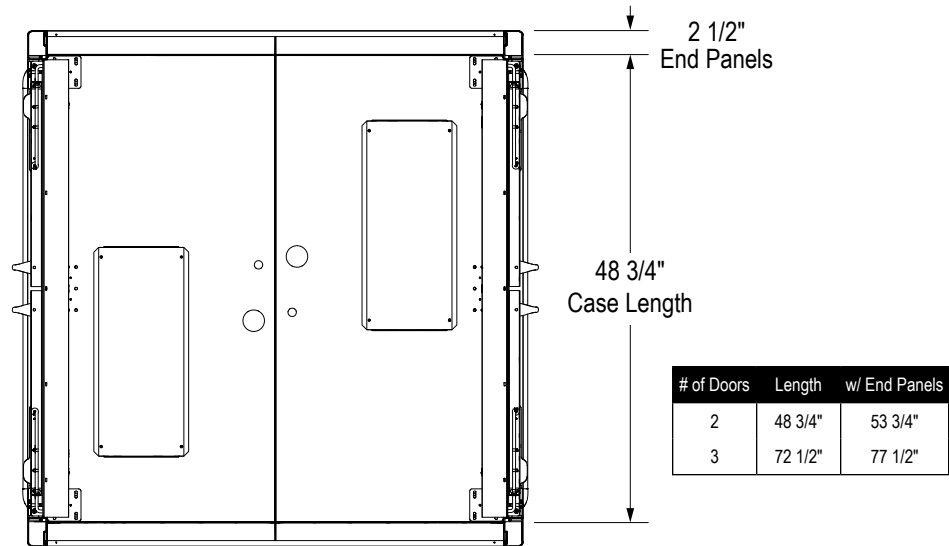

2/23/18

Specifications are subject to change without notice. All dimensions are nominal.
Case designed to operate in an ambient temperature of 75°F and relative humidity of 55% or lower.